

# Northwestern | Kellogg

## Emergency Evacuation Plan

**In the event of fire, hazardous materials release, or other hazardous situations requiring emergency response ACTIVATE THE FIRE ALARM BY PULLING AN ALARM PULL STATION AND CALL UNIVERSITY POLICE.**

For an emergency, call 911 and calmly state:

- Your name
- The building and room location of the emergency
- The nature of the emergency – fire, chemical spill, etc.
- Whether injuries have occurred
- Hazards present which may affect responding emergency personnel
- A phone number near the scene where you can be reached

## Building Evacuation

Upon hearing the fire alarm or announcement begin evacuation procedures and:

- Keep yourself and others calm.
- Quickly proceed outside the building to the announced “safe location” using the planned evacuation route. Do not stand in roadways which must be kept clear for emergency responders.
- Help those that need special assistance.
  - *If you are able, assist Non-Ambulatory persons to the Areas of Rescue Assistance located in the stairwells at each level.*
  - *Press the red help button on the emergency phone box and state your location. Ambulatory persons should then proceed to exit the building.*
- Report immediately to the designated “safe location” for your department.
- Wait for instructions from emergency response personnel.
- Do not reenter the building until told it is safe to do so.

## Evacuation Routes

LL-	<a href="https://northwestern.box.com/s/amvmjr732l3nvh7pp9fhuedmtlzow3p1">https://northwestern.box.com/s/amvmjr732l3nvh7pp9fhuedmtlzow3p1</a>
1 <sup>st</sup> Floor-	<a href="https://northwestern.box.com/s/lislgmszda44ltr3pis4h7eh5kut3wyx">https://northwestern.box.com/s/lislgmszda44ltr3pis4h7eh5kut3wyx</a>
2 <sup>nd</sup> Floor	<a href="https://northwestern.box.com/s/p5y473hmadpzkzmtmgo80t72o817yuf3">https://northwestern.box.com/s/p5y473hmadpzkzmtmgo80t72o817yuf3</a>
3 <sup>rd</sup> Floor	<a href="https://northwestern.box.com/s/vi4q0k77l0ao8zs9a9s1ncwlr1tmdn5t">https://northwestern.box.com/s/vi4q0k77l0ao8zs9a9s1ncwlr1tmdn5t</a>
4 <sup>th</sup> Floor	<a href="https://northwestern.box.com/s/e0jttc7ular4v2g46hasy1c76l8p0jzu">https://northwestern.box.com/s/e0jttc7ular4v2g46hasy1c76l8p0jzu</a>
5 <sup>th</sup> Floor	<a href="https://northwestern.box.com/s/mi5bhgy2cslr10twywr4puxllheiu5oo">https://northwestern.box.com/s/mi5bhgy2cslr10twywr4puxllheiu5oo</a>

# Northwestern | Kellogg

## Safe Locations

### Fair Weather

- Safe Area 1-Open area to the North of Cook Hall
- Safe Area 2-Open area to the South of the practice field
- Safe Area 3-Open area to the East of the Allen Center

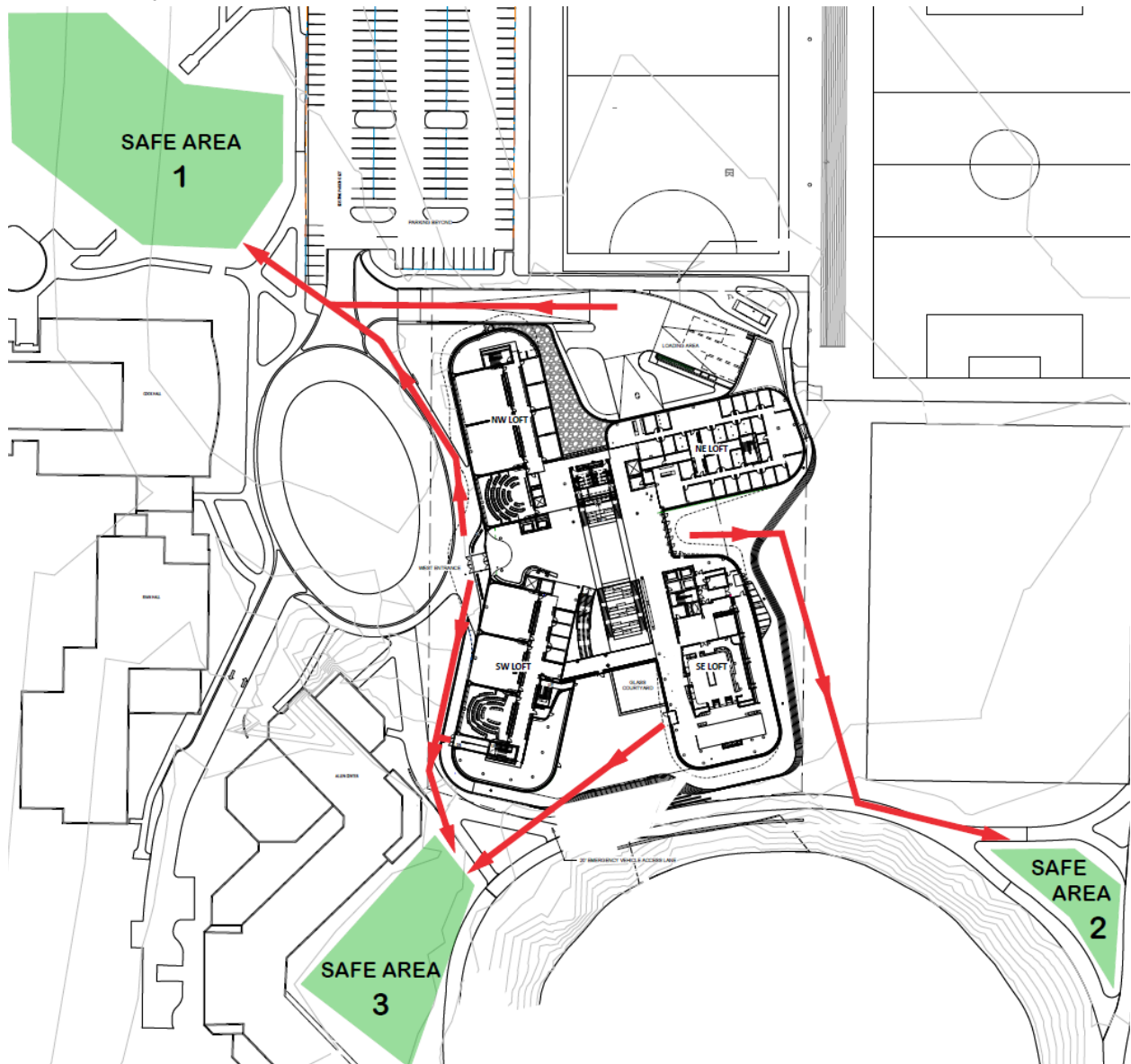

# Northwestern | Kellogg

## Inclement Weather

- Safe Area 1-Cook Hall
- Safe Area 2-Pancoe
- Safe Area 3-Allen Center

